

**DL6 70** Aluminium Sliding Door System

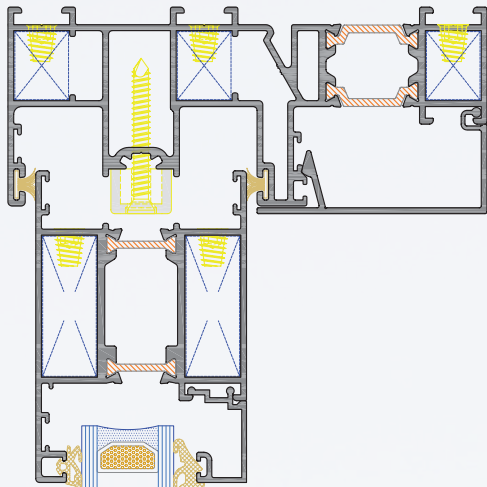

**APA**  
SYSTEMS

# DL6 70 Aluminium Sliding Door System



This newly designed DL6 70 aluminium sliding door from APA Systems contains everything that is required of a sliding door for modern day use. All complications during fabrication have been removed in this new design. The fixed panes of glass are glazed directly into the outer frame reducing sight lines. Top quality wheels are used on the sliding door which allow for large sash sizes of up to 2.0 x 2.5mts. Open-out casement sashes are easily integrated into the fixed panels. Multipoint locking is used for extra security. The polyamide assembly ensures better insulation values. Dual colour options are available.

See APA Systems Workshop Manual for technical details.



160kg load

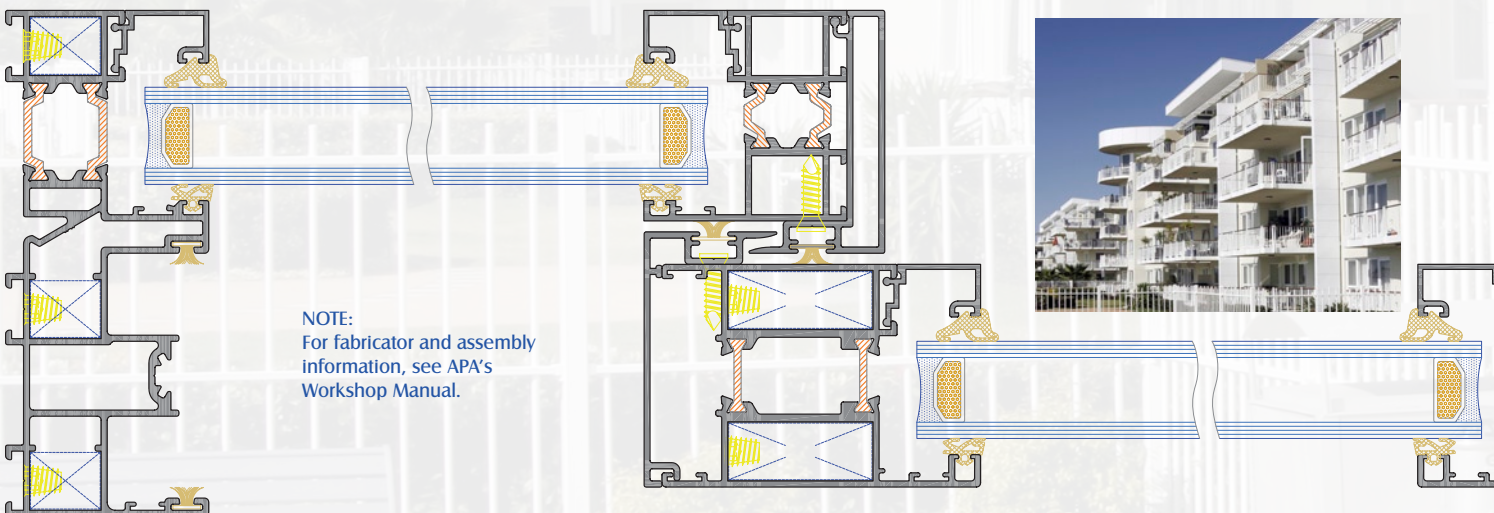
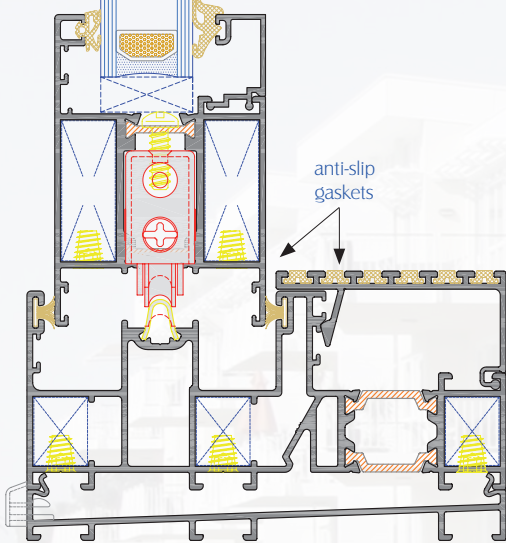

NOTE:  
For fabricator and assembly  
information, see APA's  
Workshop Manual.



## DL6 70 thermally insulated sliding door features & benefits

- High Insulation Value
- Document L compliant
- Dual colour options
- Max. weight 160kgs 2 x 2.5mt slider
- 24mm or 32mm glazing
- Variable assembly of fixed and sliding panels
- Bead glazed allowing for easy repair and on-site glazing
- Multipoint locking with anti-theft device
- Dedicated end caps reduce complications during fabrication
- Clip on in-fills
- Sight lines as small as 50mm
- Integrated drainage
- Integrated open-out sashes
- Software support by **APA-logiKal** software through APA Systems I.T. Training Centre

The APA thermally broken DL6 70 sliding door system offers great versatility when designing the feature facade of a modern residential apartment block or hotel. Single sliding doors can be incorporated into multiple fixed panel screens and integrated sashes and doors can be easily installed. Internally bead-glazed for convenience of installation and repair.

The APA DL6 70 sliding door system is assembled and coated in polyester paint using Interpon D powders applied in our modern factory under the Qualicoat Quality System. The colour can be chosen from the extensive RAL range of colours and finishes.

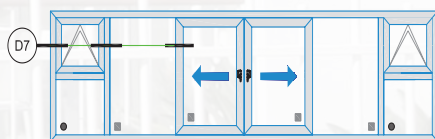
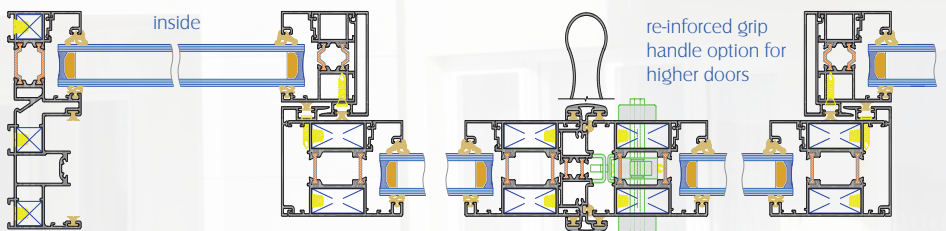
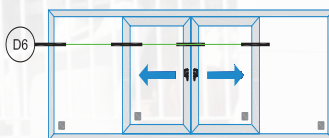
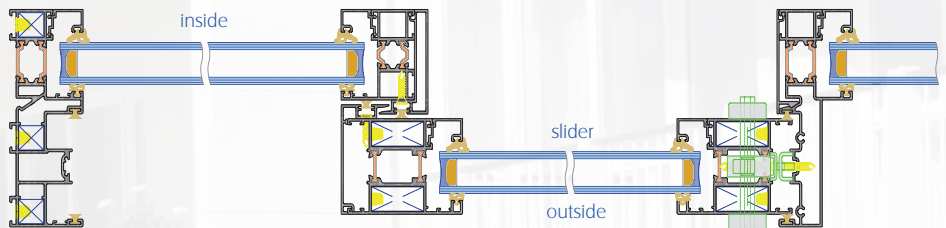
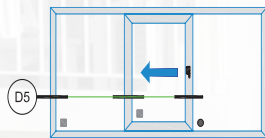
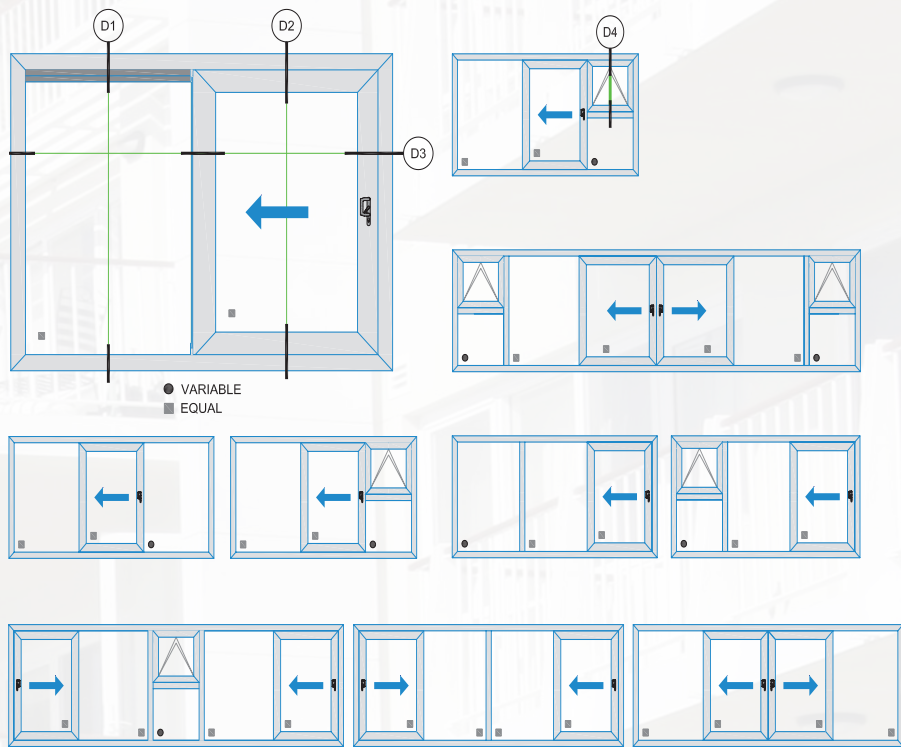

All glazing should be in accordance with BS6262 & BS6206

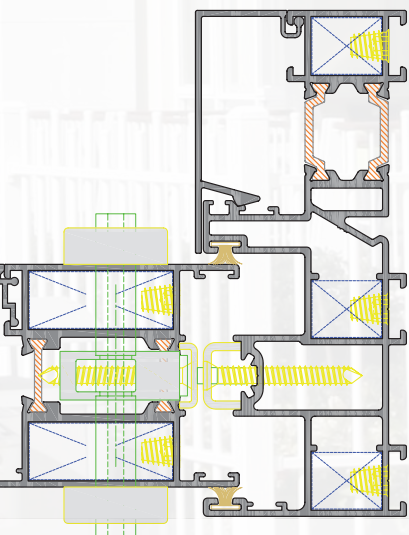
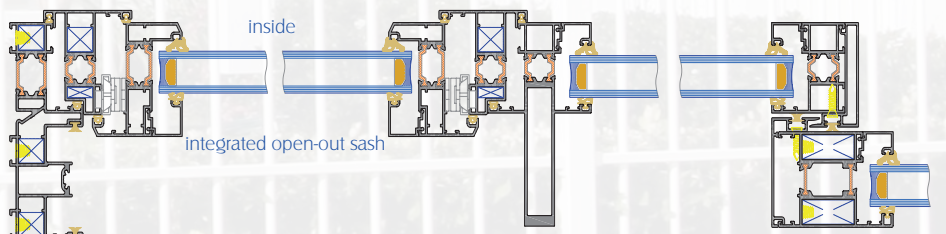

Designs may be changed without prior notice

# DL6 70 Aluminium Sliding Door System

The choice of over 200 RAL colours including dual colour make the DL6 70 Patio Door System extremely versatile for all types of environments.

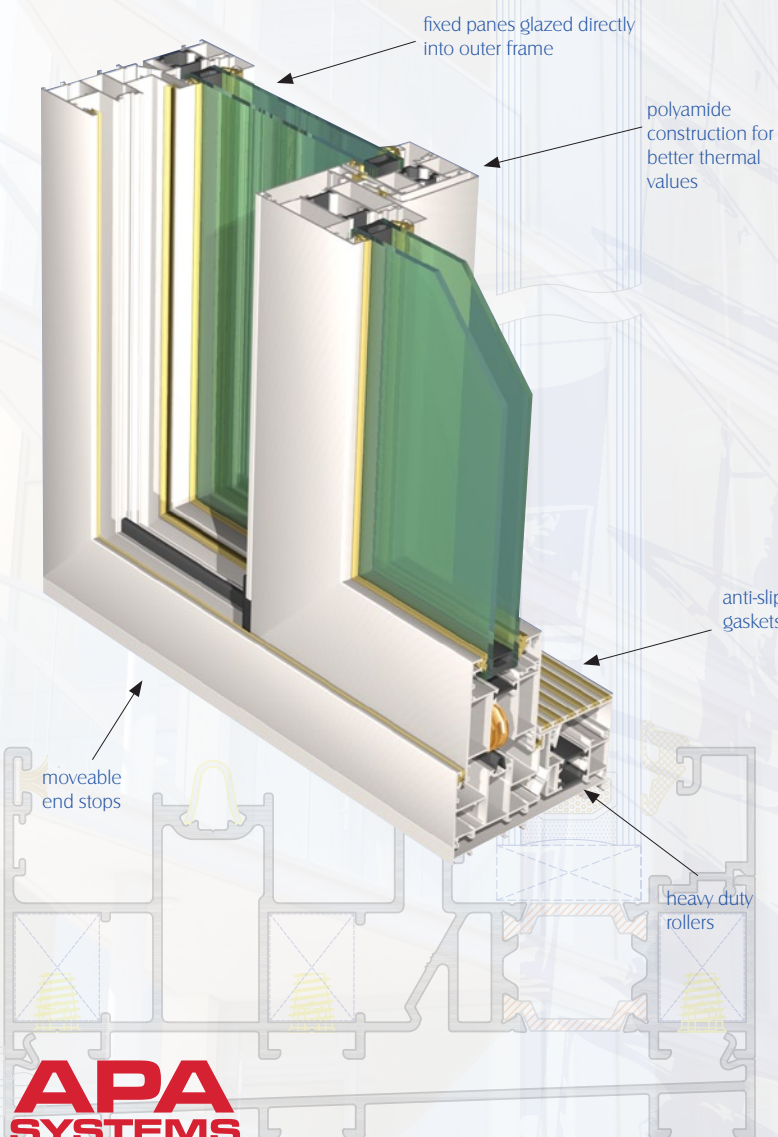

For more information on the DL6 70 Sliding Door System, please visit our website [www.apasystems.ie](http://www.apasystems.ie)

## APA products include:

- Curtain Wall Systems
- High Performance Window and Door Systems
- Structurally Bonded Framed Systems
- Atrium Rooflight Systems
- Modular Framed Systems
- Brise Soleil Systems

**APA**  
SYSTEMS

Unit 12, Parkmore Industrial Estate, Longmile Road, Dublin 12, Ireland.

Telephone: + 353 1 4509102 Fax: + 353 1 4501557/4509530 Email: [info@apasystems.ie](mailto:info@apasystems.ie) Web: [www.apasystems.ie](http://www.apasystems.ie)